

Panel height 200-595 mm

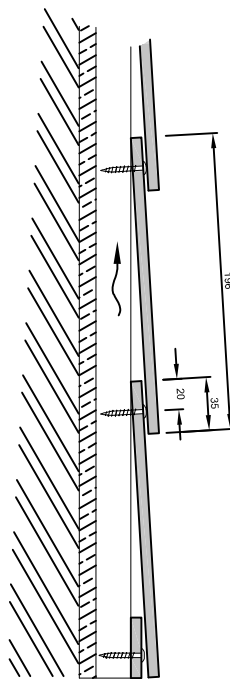

Panel height 196 mm

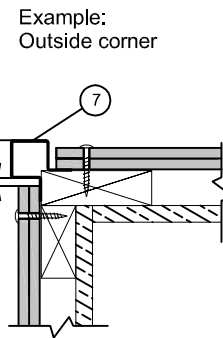
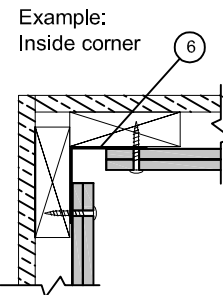

- ① Windstopper
- ②a Wooden lath, impregnated T18 - 23x73
- ②b Wooden lath, impregnated T18 - 23x48
- ③ Stainless steel screw A4: 4x35 mm
- ④ Steni Colour alt. Steni Nature Fine mlcro / Steni Imago
- ⑤ EPDM folio
- ⑥ Alu angel 50x50
- ⑦ Steni alu. corner profile CP 15-25-40

T:03_Detaljtegninger\FS detaljer\DWG\FS200_EN_02052016.dwg.

FS 200_2
Elevation and Details

Issued by/Tegnet av:
JMK

Date of Issue/Tegnet dato:
02.05.2016

Scale/Målestokk:
1:5



steni as
Tlf.: +47 33155600
www.steni.com